

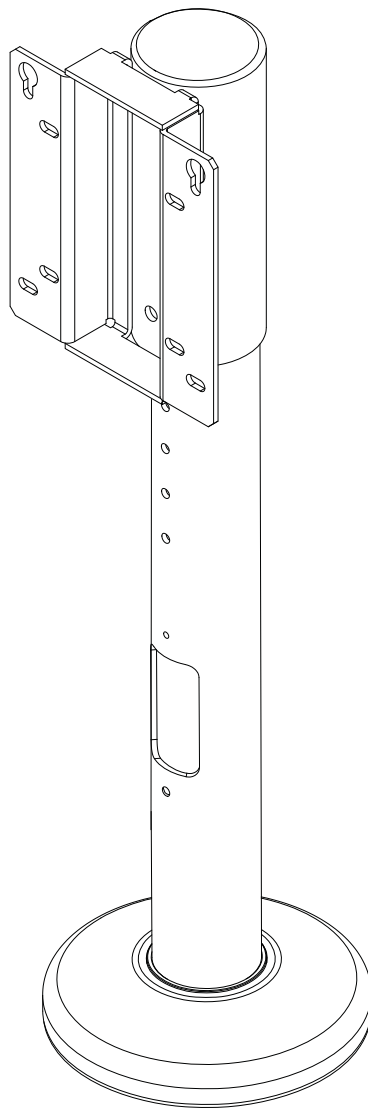

## Installation and Assembly: Desktop Swivel Mount for Westinghouse 32" and 42" LCD Screens

---

**Models: HP432-WST**



Max Load Capacity: 150 lb (68 kg)

**NOTE:** Read instruction sheet before you start installation and assembly.

*Before you begin, make sure all parts shown are included with your product.*

## Parts List

Description	Qty.	Black Part #
<b>A</b> support tube	1	090-1783-1
<b>B</b> base backer plate	1	090-1544
<b>C</b> desktop swivel base	1	090-1821
<b>D</b> adapter plate	1	090-1778
<b>F</b> thrust washer	1	590-1287
<b>G</b> 1/4 split washers	2	540-9402
<b>H</b> 1/4-20 x 1/2" phillips screw	2	510-9108
<b>I</b> M4 x 12 mm serrated socket pin screw	8	510-1079
<b>J</b> 4 mm allen wrench	1	560-9646
<b>K</b> 10/32 x 1/2" set screw	2	520-1614
<b>L</b> 1/4-20 x 1.5" threaded rod	4	520-2250
<b>M</b> 1/4-20 x 3" threaded rod	4	520-2585
<b>N</b> 1/4-20 lock nut	4	530-1021
<b>O</b> fender washer	4	540-1008
<b>P</b> loc-tite 271 thread lock adhesive (not shown)	1	570-0040
<b>Q</b> #10 SAE flat washer	4	540-9400
<b>R</b> 1/4-20 slope nut	3	530-0035

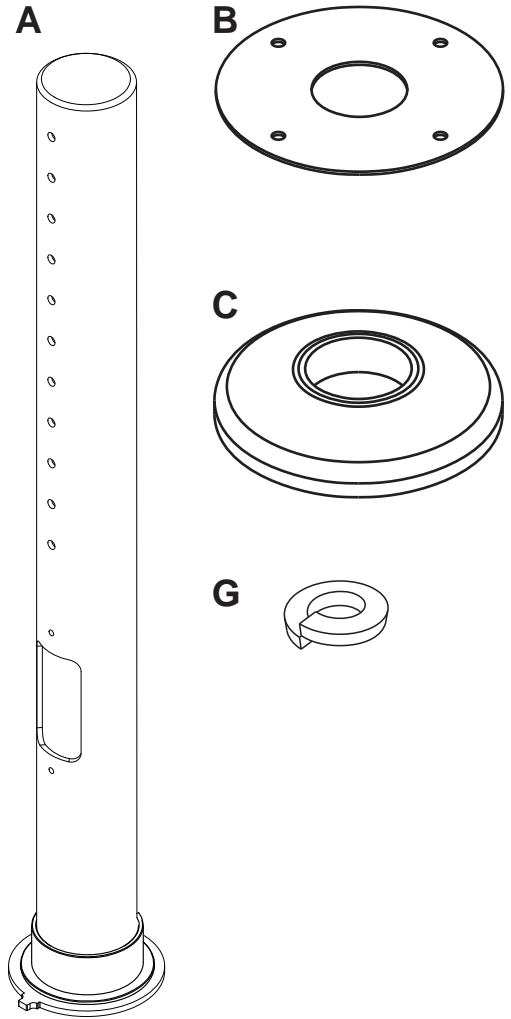

**NOTE:** Some parts may appear slightly different than illustrated.

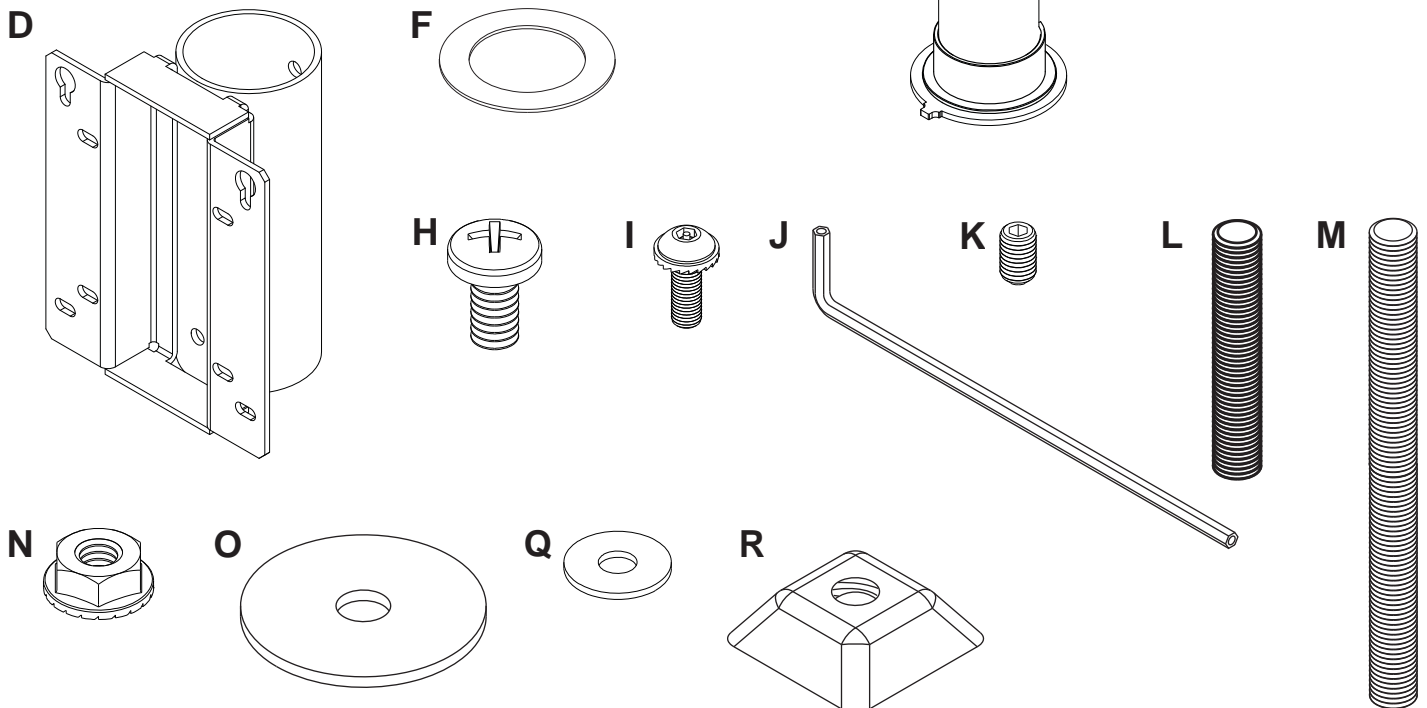

## Tools Needed for Assembly

- drill
- 9/32" drill bit
- phillips screwdriver
- 3/32" allen wrench

- 1 Use steel base (C) as a template to mark location of holes on mounting surface. Drill four holes using a 9/32" drill bit in a square formation, with steel base (C) facing the front, as shown below. In the center of the square formation drill 2" to 3" cord management hole.

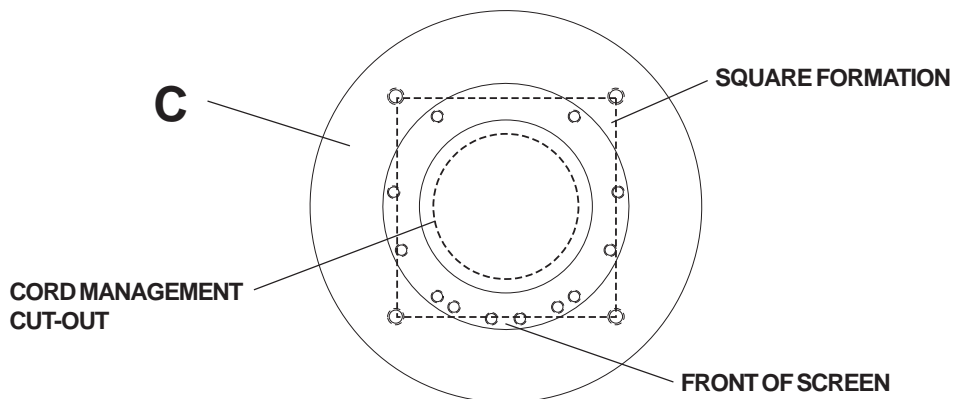

**BOTTOM VIEW**      **fig. 1.1**

## ⚠ WARNING

- Wooden mounting surface requires a minimum of 3/4" thickness to hold screen securely.

- 2 If the desk thickness is 3/4" use 1/4-20 x 1.5" threaded rods (L). If the desk thickness is between 3/4" to 2-1/4" use 1/4-20 x 3" threaded rods (M). Turn base (C) upside down and insert four threaded rods (L or M) into base (C), as shown below.

**NOTE:** Threaded rods must fasten a minimum of three turns.

**NOTE:** If enhanced security is desired, use three drops of loc-tite 271 thread lock adhesive (P) along 1/4" at the end of each threaded rod. Insert adhesive end of threaded rods (L or M) into bottom of base (C).

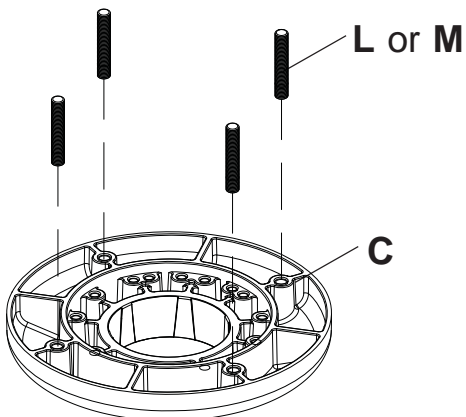

**fig. 2.1**

- 3 Turn base (C) upside down insert support tube (A), and thrust washer (F) as shown below.

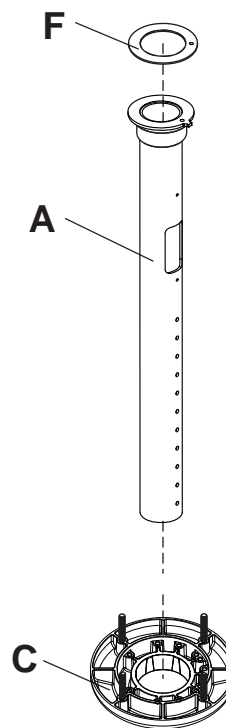

**fig. 3.1**

## Swivel Restriction

4 Referring to fig. 4.1 and 4.2, select the desired swivel degree. Fasten two set screws (K) where indicated below to the outside of desired angle in steel base (C).

**NOTE:** Set screws (K) must be bottomed out into base.

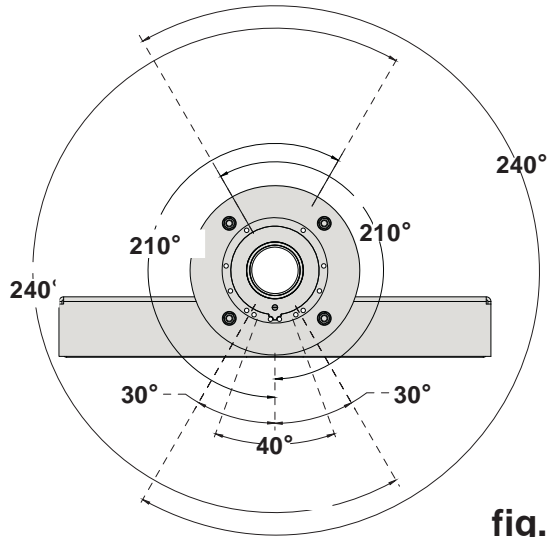

fig. 4.1

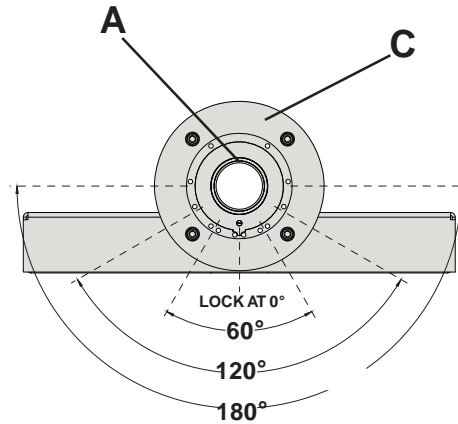
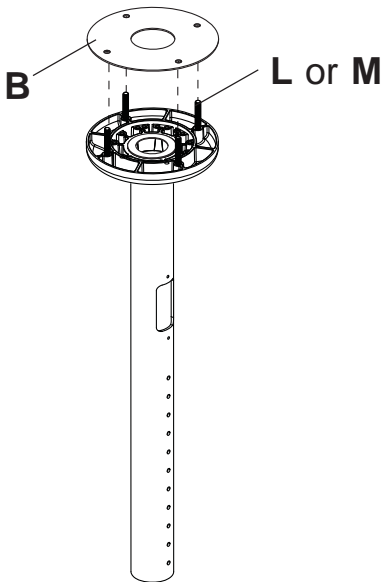

fig. 4.2

## ⚠ WARNING

- Make sure that the supporting surface will safely support the combined load of the equipment and all attached hardware and components

5 Line up backer plate (B) with threaded rods (L or M).



6 Line up base assembly (step 5), through supporting surface. Using four fender washers (O) and four lock nuts (N) tighten in numbered pattern as shown in Figure 6.1. At minimum 1/4 - 20 locknuts (N) should be flush with bottom of threaded rods (L or M) and no less than. For added security replace two of the washers and locknuts with slope nuts. Hand tighten slope nuts (R) onto two of the thread rods (L or M) till snug against bottom of table as shown in Figure 6.2. Thread another slope nut (R) upside-down, about a 3/4 turn from first slope nut (R) as shown in Detail 1. Insert a wrench between both slope nuts (R) and tighten. **NOTE:** Avoid jamming both slope nuts (R) together, doing so may make it difficult to remove slope nut used for tightening. After slope nut is secure remove bottom slope nut.

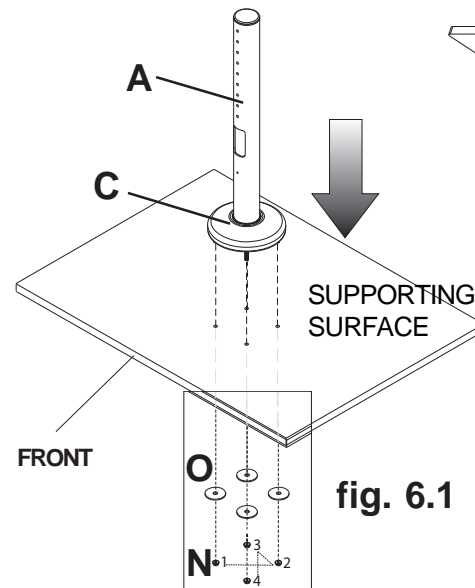

fig. 6.1

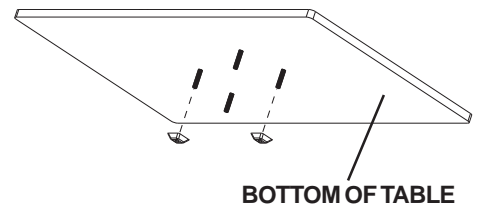

fig. 6.2



Detail 1

## CAUTION

- Installations to desktops that have a gap between two supporting boards are not acceptable mounting surfaces for the HP line of desktop swivel mounts.

- 7 Adapter plate support box (D) is adjustable up to 4" at 1" increments. Attach adapter plate support box (D) to support tube (A) as shown in fig 7.1. Fasten two 1/4-20 x 1/2" phillips screws (H) and two split washers (G) through adapter plate support box (D) and support tube (A), as shown in fig. 7.2.

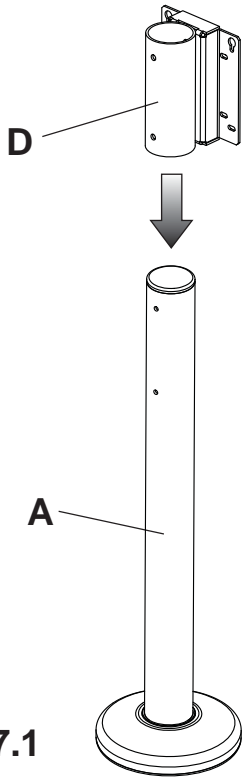

fig. 7.1

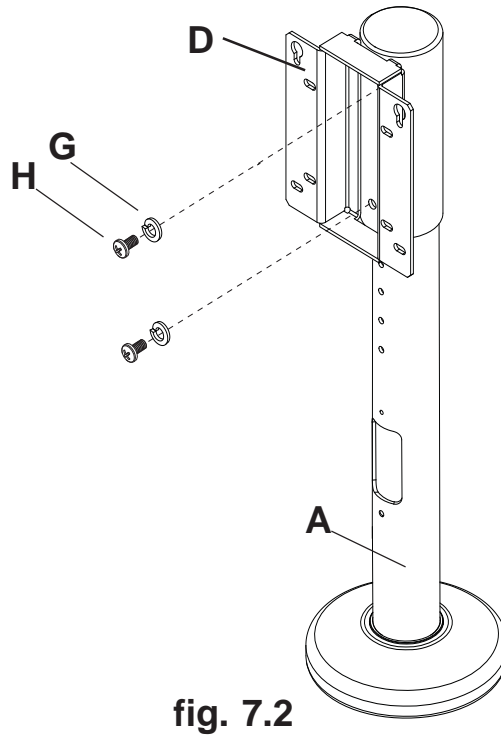
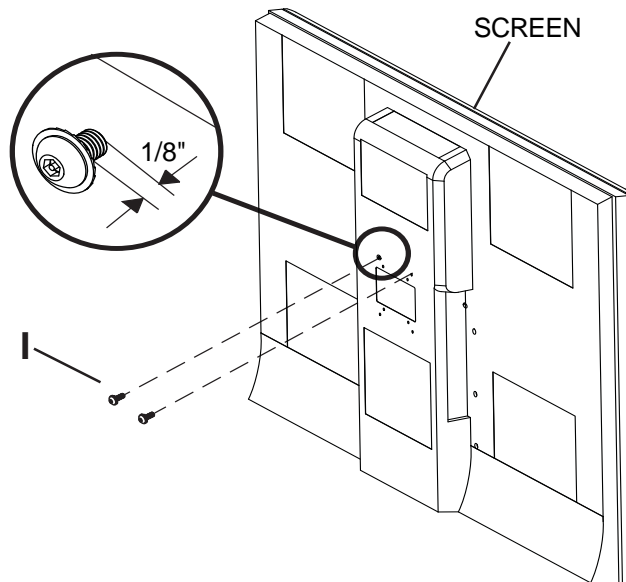

fig. 7.2

SUPPORTING SURFACE NOT SHOWN FOR CLARITY

- 8 Using the 4mm allen wrench (J), position two M4 x 12 mm serrated socket pin screws (I) leaving 1/8" exposed thread.



SUPPORTING SURFACE NOT SHOWN FOR CLARITY

**9** Hook screen onto adapter plate using keyhole slots as shown.

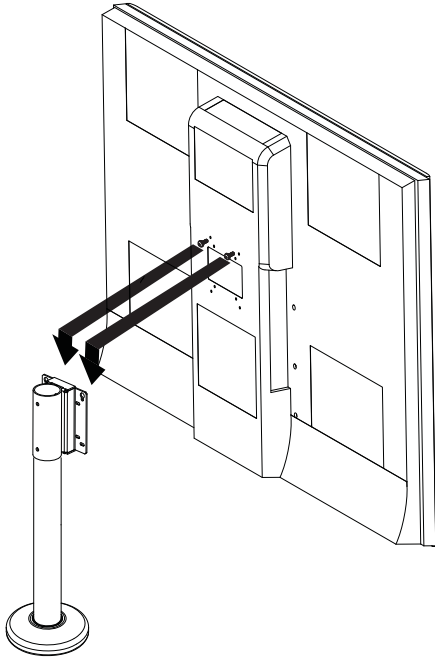

**10** Using the 4mm allen wrench (**J**), secure screen to adapter plate (**D**) using six M4 x 12 mm serrated socket pin screws (**I**). Tighten screws.

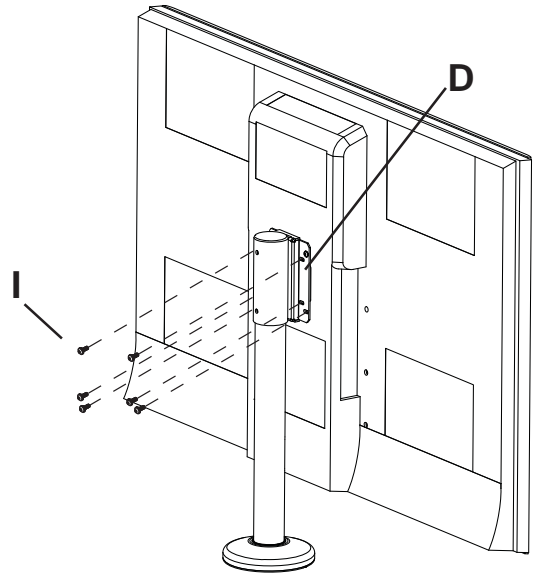

**SUPPORTING SURFACE NOT SHOWN FOR CLARITY**